



HMCK Series

The ultimate solution for demanding level control. Multi-function level switches in custom lengths, delivering outstanding flexibility.

- Extra robust terminal box in metal
- Adjustable G1" compression fitting and flange
- Selectable switch point lengths and contact functions*



HM 2511

Sensors with REED technology without power consumption, manufactured with the highest quality in our ISO-certified factory in Roslagen, Sweden.

General description:

HMCK. The float level switches are available with up to four functions in the same unit. It can also be combined with a built-in temperature sensor or overtemperature protection. Suitable for oil and other non aggressive liquids.

Construction:

Extra robust terminal box in powder-coated aluminum. Protection class IP66. Terminals connection for mounting your own cable.

Adjustable G1" compression fitting, when the nut is tightened, the coupling is fixed to the probe. Probe in brass, floats in NBR.

* We manufacture the sensor in desired lengths. Specify switch points length (mm) and contact function when ordering.

O : NO, open at low level, closes rising

S : NC, closed at low level, opens rising

V : NO/NC, change-over

T : Overtemperature protection. NC, opens rising at 70°C ±5

TA90: Thermostat NO/NC adjustable 30...90°C

Options, special on request:

Overtemperature protection with other switching temperature and smaller hysteresis.

Built-in temperature sensor Pt100, Pt1000, 4-20mA and 0-10V.

HEMOMATIK Sweden

Liquid level switch with thermostat

Art.nr. HMCK-VVTA90

V=..... mm, V=..... mm

Drawing nr. HMCK-VVTA90

Rev. 6

Approved P.L. 940614

Scale 1:2

TA= adjustable 30-90°C, change over

Date 940607

Sign. MEM

Rev. date 251201



Note! Read this instruction before installation and use

Protective earth

Rights to the design and drawing belongs to HEMOMATIK Sweden, copyright ©

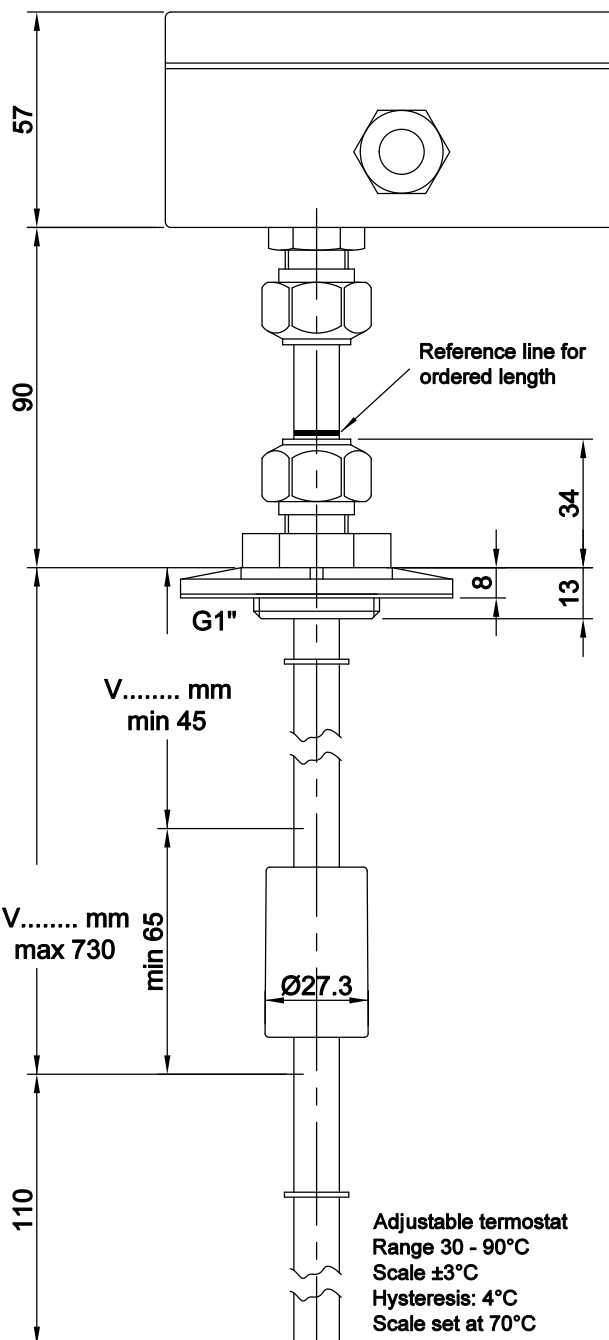
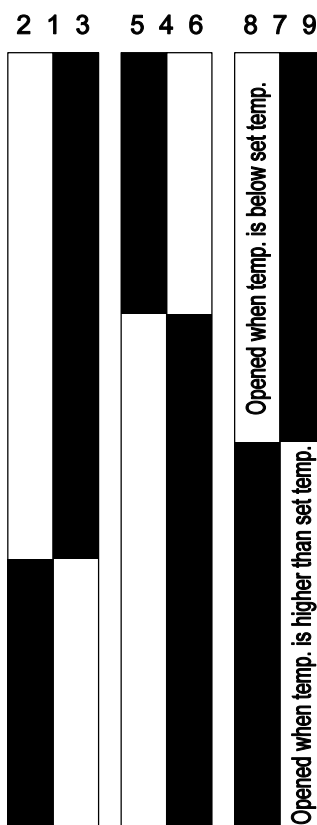

FEATURES

Float liquid level sensor with REED-technology to activate pumps or valves via relays or PLC. Suitable for oil and other non aggressive liquids

MATERIALS

Probe : Brass
Float : NBR S.G. 0,42
Fitting : Brass
Flange : PA6
Gasket : Nitrile
Terminalbox: powder-coated aluminum

Temp. media : -20...+100°C
Temp. ambient : -20...+70°C
For use 0-5000m above MSL

CONTACT SYMBOLS

V = change over

PROTECTION DEGREE

Terminal box : IP67
Probe : IP68

INSTALLATION

Adjustable compression fitting, when the nut is tightened, the coupling is fixed to the probe.

ELECTRICAL MAX DATA

Contact rating *	60 VA
Voltage	3-230 V AC/DC DC to 60Hz
Current	1 A

* = resistive load

WARNING! If no protective earth is connected to the sensor, the supply voltage must not exceed 48V AC/DC

■ = Switch closed

□ = Switch open