



Mass Flow Sensors for high temperature applications

FS7306 series

The products are designed for high temperature (<150°C) mass flow metering. The electronics as well as the package ensures the long term reliability. Alternative package for higher temperature is possible upon requests.

Features

- ✘ Working at up to 120°C
- ✘ Instant flowrate via data cable
- ✘ Standard RS485 Modbus communication
- ✘ Gas flowrate high/low alarm
- ✘ Long term reliability

Applications

- ⌚ Process gas status monitoring
- ⌚ Glass vacuum detection
- ⌚ Laboratory and testing
- ⌚ Bio and pharmaceutical fermentation
- ⌚ Fuel cell efficiency

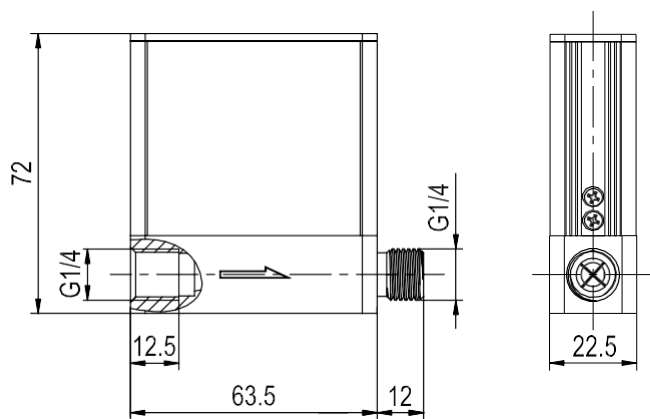

Specifications

Model	FS7306	Unit
Flow range	0 ... 10	SLPM
Accuracy	±2.5FS	%
Repeatability	±1.0	%
Power supply	12 ~ 24	Vdc
Working current	<5.0 @24Vdc	Vdc
Pressure rating	-95 ~ 200	kPa • g
Temperature rating	0 ~ 120	°C
Maximum temperature	150	°C
Interface	RS485 (Modbus)	
Protection	IP40	
CE	EN 61000-6-1 to 6-4	
Connectivity	Serial, max. 200 units	
Mech. connection	G 1/4"	
Standard conditions	101.325 kPa; 20°C	

Notes: * The above parameters are applicable at 20°C and 101.325kPa, air calibration.

** At the high temperature the parameters may be subject to temperature coefficient related shift.

Order information

The sensor part number is composed of the model number and suffix indicating the full scale flow rate, output format as well as the calibration gas. Refer to the followings for details.

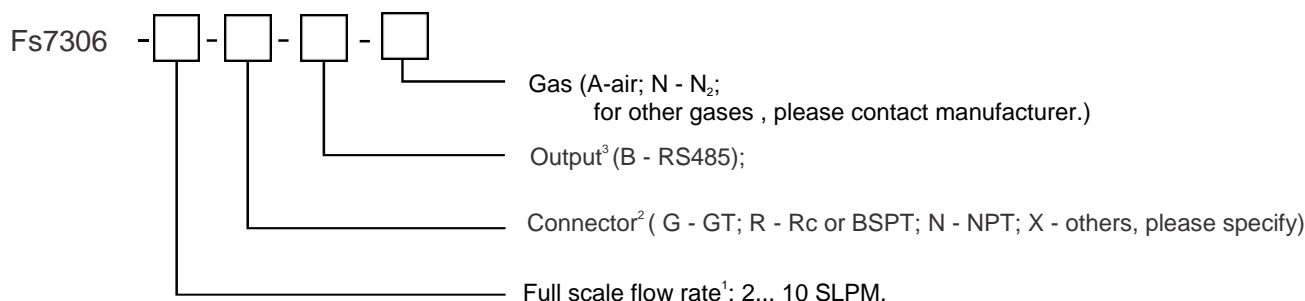

1. Numerical maximum flow rate only, for example, 10 meaning full scale flow rate of 10SLPM.

2. For other mechanical connectors, please contact manufacturer.

3. The sensors are default with the standard RS485 Modbus.

© 2018 Siargo. The company reserves the rights to change the product specifications without the prior notice.
For further information, please contact the manufacturer.