



HM 2211

MEMS Mass Flow Meters

For low pressure applications

MF-GD Series

MF-GD series utility gas mass flow meters were first introduced in 2009 and the current version is the 3rd generation of the company's MEMS utility gas meters designed for city natural gas metering. The current upgrades include automatic gas recognition, a new mechanical design with a flanged connection, better power management, and enhanced long-term reliability. The products are also deployed for control and improvement of burner efficiency using natural gases.

MF-GD covers most of the models for commercial city gas metering applications.

Dimensions

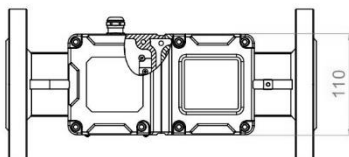
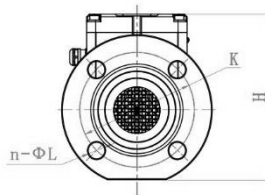
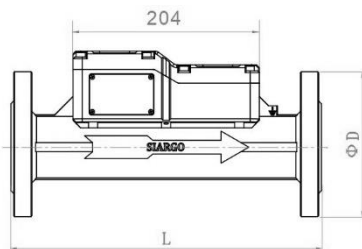

| | L | H | Φ D | n-Φ L | Φ K |
|--------|-----|-----|-------|--------|-------|
| MF25GD | 300 | 156 | Φ 115 | 4-Φ 14 | Φ 85 |
| MF40GD | 320 | 175 | Φ 150 | 4-Φ 18 | Φ 110 |
| MF50GD | 340 | 181 | Φ 165 | 4-Φ 18 | Φ 125 |
| MF80GD | 340 | 215 | Φ 200 | 8-Φ 18 | Φ 160 |



Specifications

| | | |
|--------------------------|---------------------------------------|-------|
| Accuracy | $\pm(1.5+0.25FS)$ | % |
| Rangeability | 100:1 | |
| Pressure rating | 0.2 | MPa |
| Temperature, gas | -20 ~ 65 | °C |
| Temperature, environment | -40~60 | °C |
| Humidity | <95 (no condensation) | %RH |
| Power supply | 2 x D-Cell lithium-ion, 19Ah (L3638A) | |
| Battery life | > 36 | Month |
| Realtime clock | 10 | Year |
| Output | RS485 Modbus or pulsed with 8~24Vdc | |
| Mechanical | Flanged | |
| Protection | IP66 | |
| Hazardous rating | Ex ia II C T ₄ | |
| Calibration | Air @ 20°C, 101.325 kPa | |
| Storage temperature | -20 ~ 70 | °C |

Product selection

| Model | DN (mm) | Flow range (m³/h) | | | |
|--------|---------|-------------------|----------|---------|---------|
| | | -1 | -2 | -3 | -4 |
| MF25GD | 25 | 0.10~10 | 0.16~16 | 0.25~25 | 0.40~40 |
| MF40GD | 40 | 0.25~25 | 0.40~40 | 0.65~65 | -- |
| MF50GD | 50 | 0.40~40 | 0.65~65 | 0.80~80 | -- |
| MF80GD | 80 | 1.00~100 | 1.60~160 | -- | -- |

Note: For other gases and flow ranges, please contact the manufacturer. For example, if applied to CO₂ measurement, a model selection can be MF25GD-30-B-C: 30 is the maximum flow rate (80% of air); and B for RS485 Modbus; C for CO₂.